



February 25, 2021

Re: 375 Washington Ave. North Haven EV Charger Installation

Alan Fredricksen  
North Haven CT Department of Land Use  
5 Linsey Street  
North Haven, CT 06473

Greetings Mr. Fredricksen,

I am contacting you today to request use of existing parking spaces located at 375 Washington Ave. North Haven, to be used for the purpose of charging electrified vehicles. This is a Volvo Dealership. Two spaces, utilizing a single Level 2 9.6kW Dual Charger, will be for public use. Two other spaces will have individual dedicated Chargers, one 12kW AC Level 2 Charger and the other 24kW DC Level 3 Charger, for dealership use to charge new vehicles and recently serviced vehicles. All three Chargers will be wall mounted to the dealership's exterior wall.

I have included a section of the site plan highlighting the parking spots that they would like to utilize for the above stated purposes. I have also included a small legend detailing each charger's location in relation to the building.

Please let me know if any additional information is need or if I can answer any questions. My contact information is below. I look forward to hearing back from you soon.

Thank you,

A handwritten signature in black ink, appearing to read "Chris Gaylor", written over a white background.

Christopher Gaylor

Project Manger  
Elm Electrical Inc.  
413.883.6596  
cgaylor@elmelec.com

RECEIVED

MAR 16 2021

TOWN of NORTH HAVEN  
LAND USE AND DEVELOPMENT

**GENERAL NOTES:**

PROFESSIONAL ENGINEER'S SEAL/SIGNATURE, ORIGINAL DOCUMENT CONTAINS THE LIVE SEAL AND LIVE SIGNATURE OF THE PROFESSIONAL ENGINEER. THIS DOCUMENT SHALL BE CONSIDERED UNSEALED AND UNSIGNED BY THE PROFESSIONAL ENGINEER IF SUCH SEAL AND SIGNATURE ARE MISSING OR IF IT CONTAINS A SEAL AND/OR SIGNATURE THAT ARE COPIES.  
 CALL BEFORE YOU DIG 1-800-922-4455. EXISTING UTILITIES HAVE BEEN PLOTTED FROM AVAILABLE SOURCES. THE LOCATIONS ARE ONLY APPROXIMATE AND NOT GUARANTEED. THE CONTRACTOR SHALL VERIFY THE LOCATION AND DEPTH OF ALL UTILITIES WITHIN THE PROJECT AREA. THE CONTRACTOR SHALL NOTIFY EACH AFFECTED UTILITY COMPANY AND DIG TEST PITS AS REQUIRED PRIOR TO COMMENCING CONSTRUCTION. MEEHAN & GOODIN MAKES NO STATEMENT AS TO THE CONDITION OR SUITABILITY OF ANY UTILITIES FOR ANY INTENDED USE.  
 ALL PROPRIETARY PRODUCTS AND MATERIALS SHALL BE INSTALLED AND MAINTAINED IN ACCORDANCE WITH THE MANUFACTURER'S RECOMMENDATIONS. ON ALL DISTURBED AREAS THAT WILL NOT BE COVERED BY BUILDING, PAVEMENT, OR OTHERWISE PERMANENTLY STABILIZED, PLACE TOPSOIL (6 INCH MINIMUM) AND ESTABLISH GRASS TURF UPON COMPLETION OF CONSTRUCTION.  
 THE CONTRACTOR SHALL ADJUST FINAL GRADES TO MEET FIELD CONDITIONS AND ALL AREAS SHALL BE GRADED TO DRAIN.  
 IMPROVEMENTS SHOWN ON THIS PLAN RELATING TO PROPOSED WORK WITHIN THE PROJECT AREA SHALL BE MARKED OUT WITH THE APPROPRIATE DISTANCE WITH THE STANDARDS AND REQUIREMENTS FOR WORK WITHIN THEIR STREET LINES.

**All Vehicle Chargers are to be wall mounted.**

**9.6kW AC Dual Level 2 Charger**  
**12kW AC Level 2 Charger**  
**24kW DC Level 3 Charger**

**LEGEND**

PROPERTY LINE	O B	BOLLARD
EASEMENT LINE	X H/D	HYDRANT
SANITARY SEWER	PY/SV/RY	FRONT/SIDE/REAR YARD
OVERHEAD WIRES	CLF	CHAIN LINK FENCE
WATER DRAINAGE	TF	TOP OF FRAME
ELECTRIC SERVICE	LP	FLOWLINE
TELEPHONE SERVICE	GM	LIGHT POLE
FENCE	FL	GAS METER
IRON PIN	ET	FLOOD LIGHT
CONCRETE KERESTONE	WHF	ELECTRIC TRANSFORMER
UTILITY POLE	O RL	WATER METER PIT
SANITARY/DRAINAGE MANHOLE	DOT	ROOF LEADER
WATER GATE/GAS GATE	48-25	DOOR/OVERHEAD DOOR
CATCH BASIN/DRYWELL	48-25	BOTTOM IN DRYWELL
	48-25	EXISTING CONTOUR
	48-25	EXISTING SPOT GRADE
	48-25	TEST PIT

**NEW YORK CENTRAL LINES LLC**  
**C/O CSX TRANSPORTATION INC**  
**ZONE 11-80 ACROSS RAILROAD TRACKS**

**325 LAFAYETTE STREET ASSOC. LLC**  
**MAP 85 - LOT 012**  
**4846 WASHINGTON AVENUE**  
**ZONE 11-30**

**365 WASHINGTON AVE LLC**  
**MAP 85 - LOT 018**  
**4865 WASHINGTON AVENUE**  
**ZONE 11-30**

**N/P MLPTI LLC**  
**MAP 85 - LOT 014**  
**4888 WASHINGTON AVENUE**  
**ZONE 11-30**

**N/P WASHINGTON AVE PARTNERS LLC**  
**MAP 80 - LOT 008**  
**4609 WASHINGTON AVENUE**  
**ZONE 11-80**

**465 WASHINGTON AVE PARTNERS LLC**  
**MAP 80 - LOT 008**  
**4609 WASHINGTON AVENUE**  
**ZONE 11-80**

**NEW 12'x12' CONC. DUMPSTER PAD**  
**SCREENED W/ 6" HIGH FENCE AND GATE**

**NEW 12'x20' BITUMINOUS PAVEMENT AREA**

**NEW PAINTED STRIPING ON EXIST. PAVEMENT (TYP.)**

**NEW BITUMINOUS PAVEMENT SECTION**

**NEW 5' MONOLITHIC CONC. WALK**

**2 NEW PAINTED EMPLOYEE PARKING SPACES @ 9'x22'**

**2 NEW PAINTED PARKING SPACES**

**2 NEW PAINTED PARKING SPACES**

**NEW PAINTED PARKING STRIPING (TYP.)**

**NEW LIGHT RAB-358W-2-900**

**NEW LIGHT RAB-358W-3-1200**

**NEW LIGHT RAB-358W-2-900**

**NEW LIGHT RAB-358W-2-900**

**NEW LIGHT RAB-358W-2-900**

**NEW LIGHT RAB-358W-2-900**

**NEW LIGHT RAB-358W-2-900**

**LIGHTING FIXTURE SCHEDULE**

SYMBOL	QTY.	LABEL	DESCRIPTION	MANUFACTURER	CATALOG NUMBER	TOTAL WATTS
Ⓛ	6	RAB-358W-2-900	ALED/ 13605F/ 480V/ PCT4	RAB LIGHTING INC.	ALED413605/480/D10 - WPNA.	4304.4
Ⓜ	3	RAB-358W-3-1200	ALED/ 13605F/ 480V/ PCT4	RAB LIGHTING INC.	ALED413605/480/D10 - WPNA.	3228.3

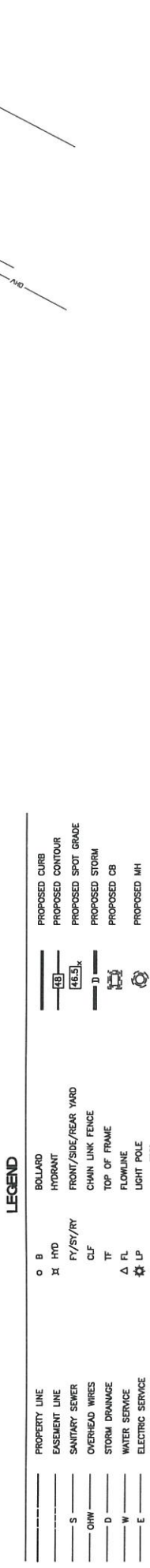
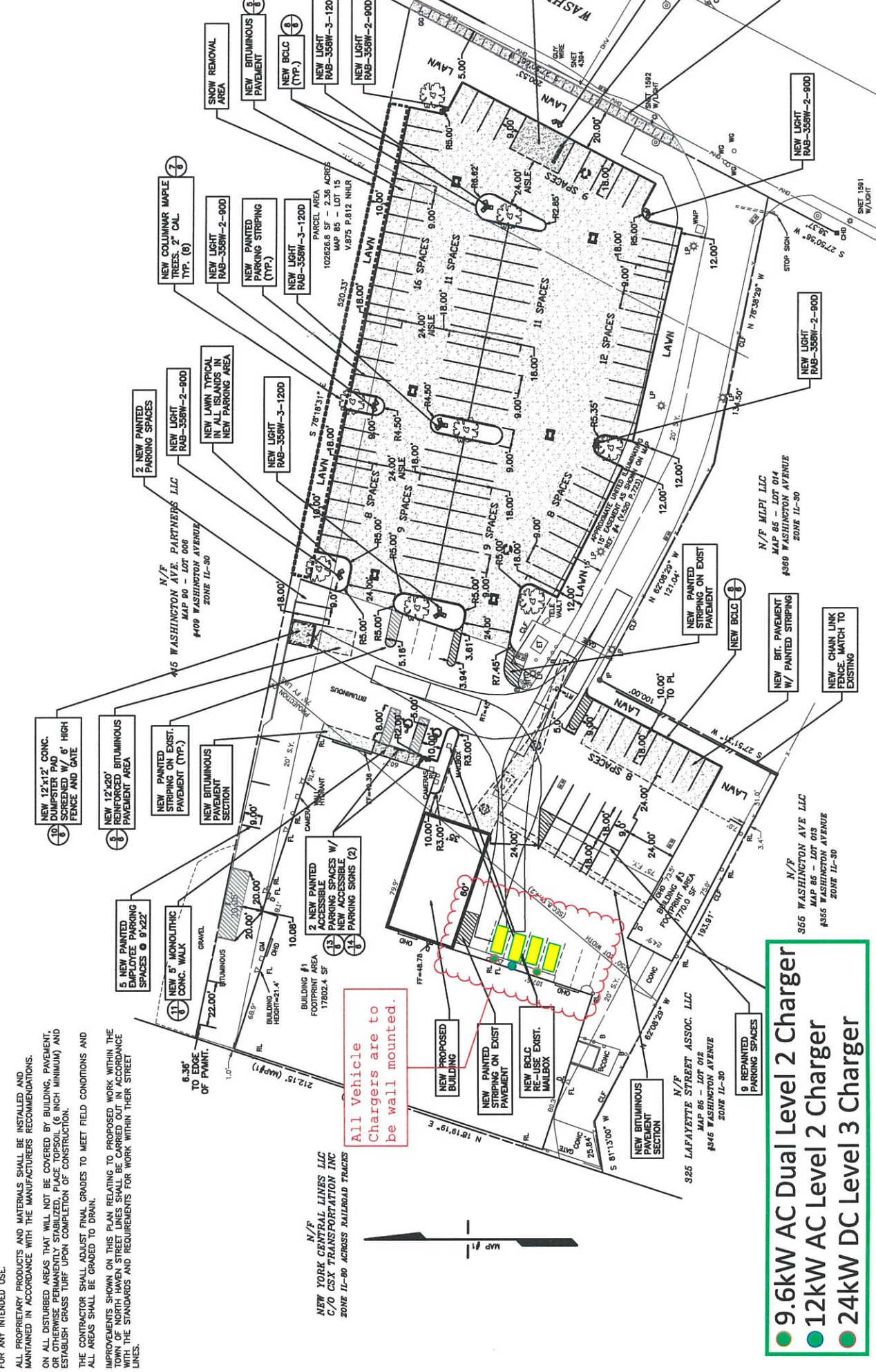

**REVISION**

REVISION	DATE
1. SANITARY AND LAYOUT ADDITIONS.	07-29-18

**Meehan & Goodin**  
 Engineers - Surveyors, P.C.  
 387 North Main Street, Manchester, CT 06042  
 (860) 643-2520 FAX (860) 649-8806

**GENGRAS MOTORS**  
 375 WASHINGTON AVE.  
 NORTH HAVEN, CONN.

**LAYOUT PLAN**

SCALE: 1" = 30'  
 DATE: 06-08-2018  
 PROJECT: 18-026  
 DESIGN: DT  
 DRAFT: DT

PLAN PREPARED FOR  
**GENGRAS MOTORS**

DATE: 07-29-18

NOTE:  
 THIS DRAWING IS AN INSTRUMENT OF SERVICE. IT IS THE PROPERTY OF MEEHAN & GOODIN, INC. AND IS NOT TO BE REPRODUCED, COPIED, OR TRANSMITTED IN ANY FORM OR BY ANY MEANS, ELECTRONIC OR MECHANICAL, WITHOUT THE WRITTEN CONSENT OF MEEHAN & GOODIN, INC. ALL DIMENSIONS SHALL BE AS SHOWN UNLESS OTHERWISE NOTED.